

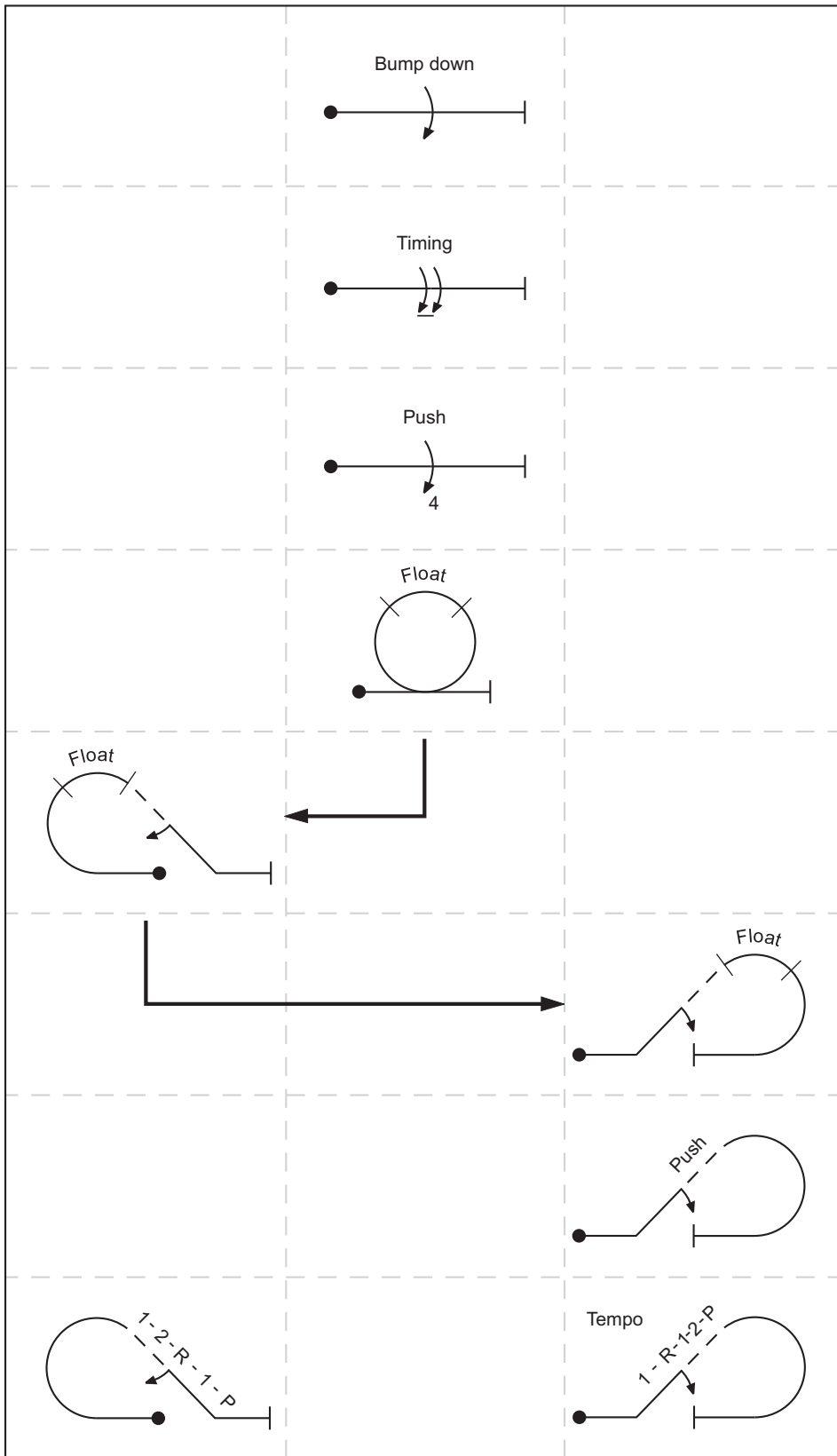

# Symmetry Instruction Outline



- Horizontal roll w/bump of down elevator passing through inverted C-20
- Consecutive rolls w/bumps up, down, up, down, up C-25
- 4-point roll w/push inverted C-27
- Float over top of loop D-33
- Float reg. half Cuban D-37
- Float reverse half Cuban D-39
- Push on 45? D-38
- Balanced 45's in reg. and reverse Cubans D-41



# P-factor Instruction Outline (Pull-Right / Push-Left)



DAS  
PHASE II

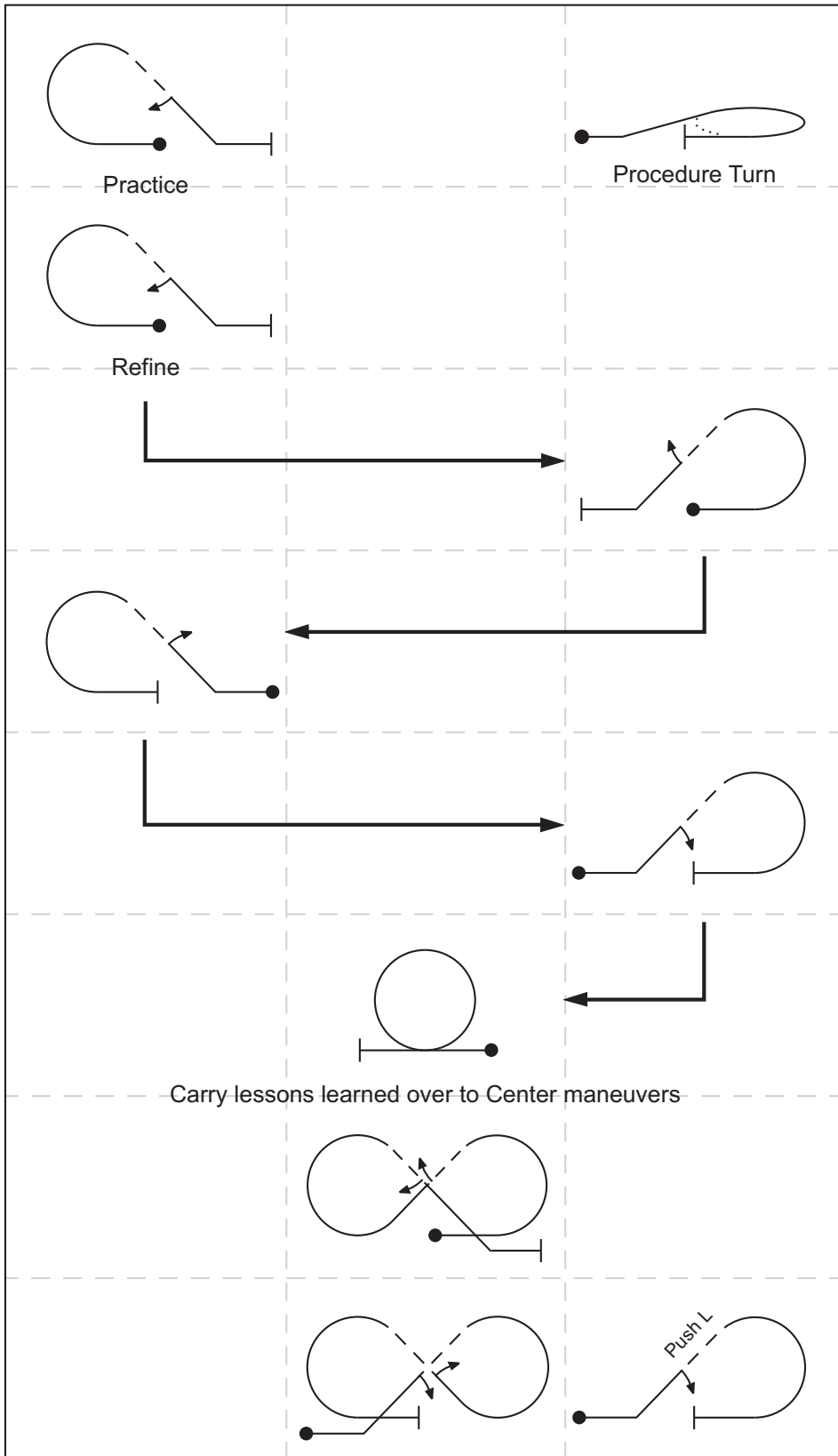

P-factor right rudder correction in Cuban at one end of flying field E-81

Practice and refine

P-factor correction in Cuban at other end of field

P-factor correction in reverse Cuban E-82

P-factor correction in reverse Cuban at other end of field

P-factor correction in loop at show center E-80

P-factor corrections in full Cuban

P-factor corrections in full reverse Cuban. Negative P-factor Left rudder correction on push? E-84



# AWAY X-wind Instruction Outline



DAS  
PHASE II

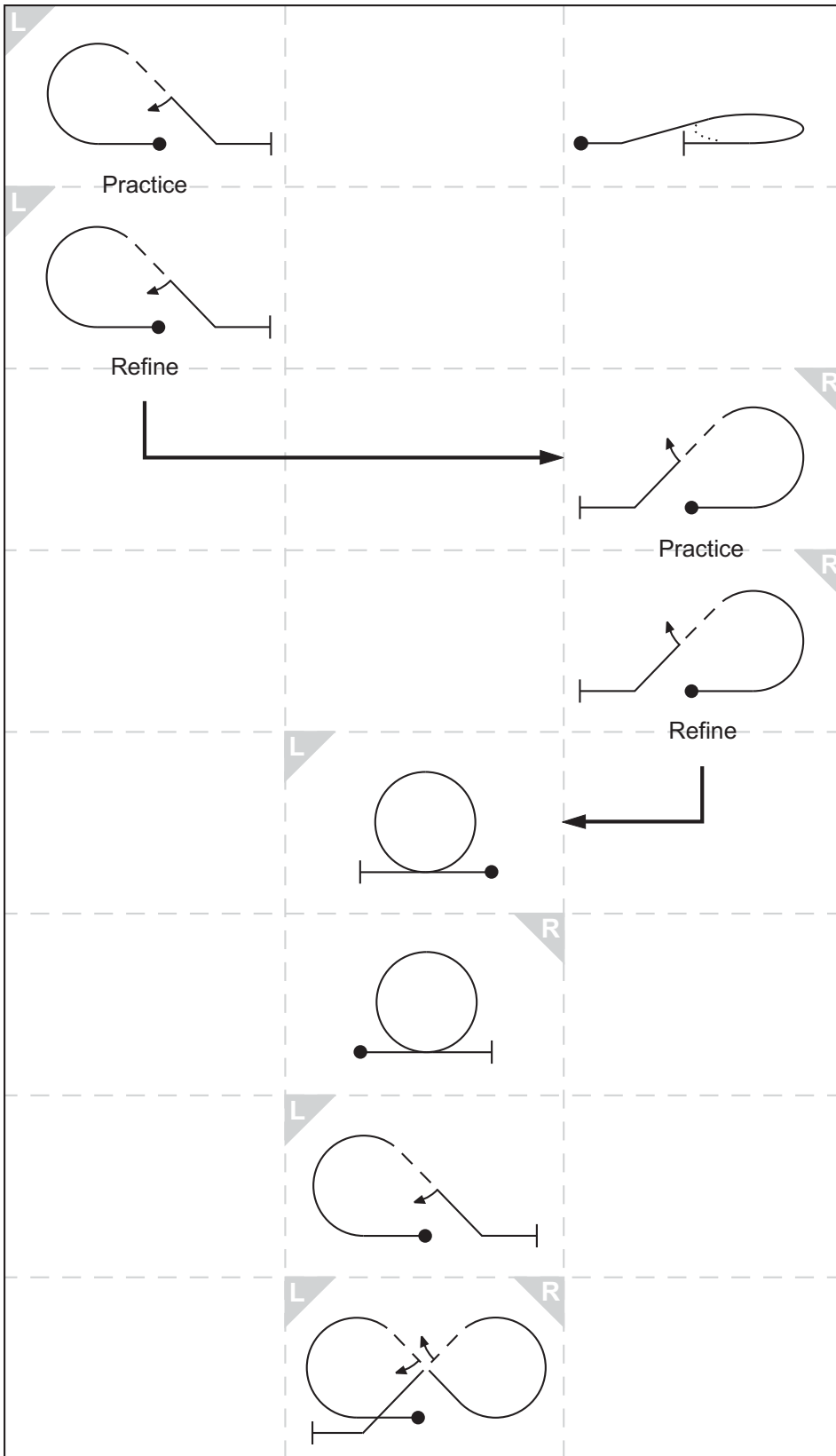

- Practice rudder wind correction in Cuban at one end of field E-54
- Refine wind correction E-57
- Practice wind correction in Cuban at other end of field E-56
- Refine E-58
- Apply wind correction to loop at show center E-50
- Wind correct loop in opposite direction E-77
- Wind correct half Cuban at show center E-73
- Full Cuban w/wind corrections E-74

KPTR: *Knowhow* causes one to look at a windsock and stay ahead of wind drift, *not* reflexes!



# AWAY X-wind Instruction Outline Cont.



DAS  
PHASE II

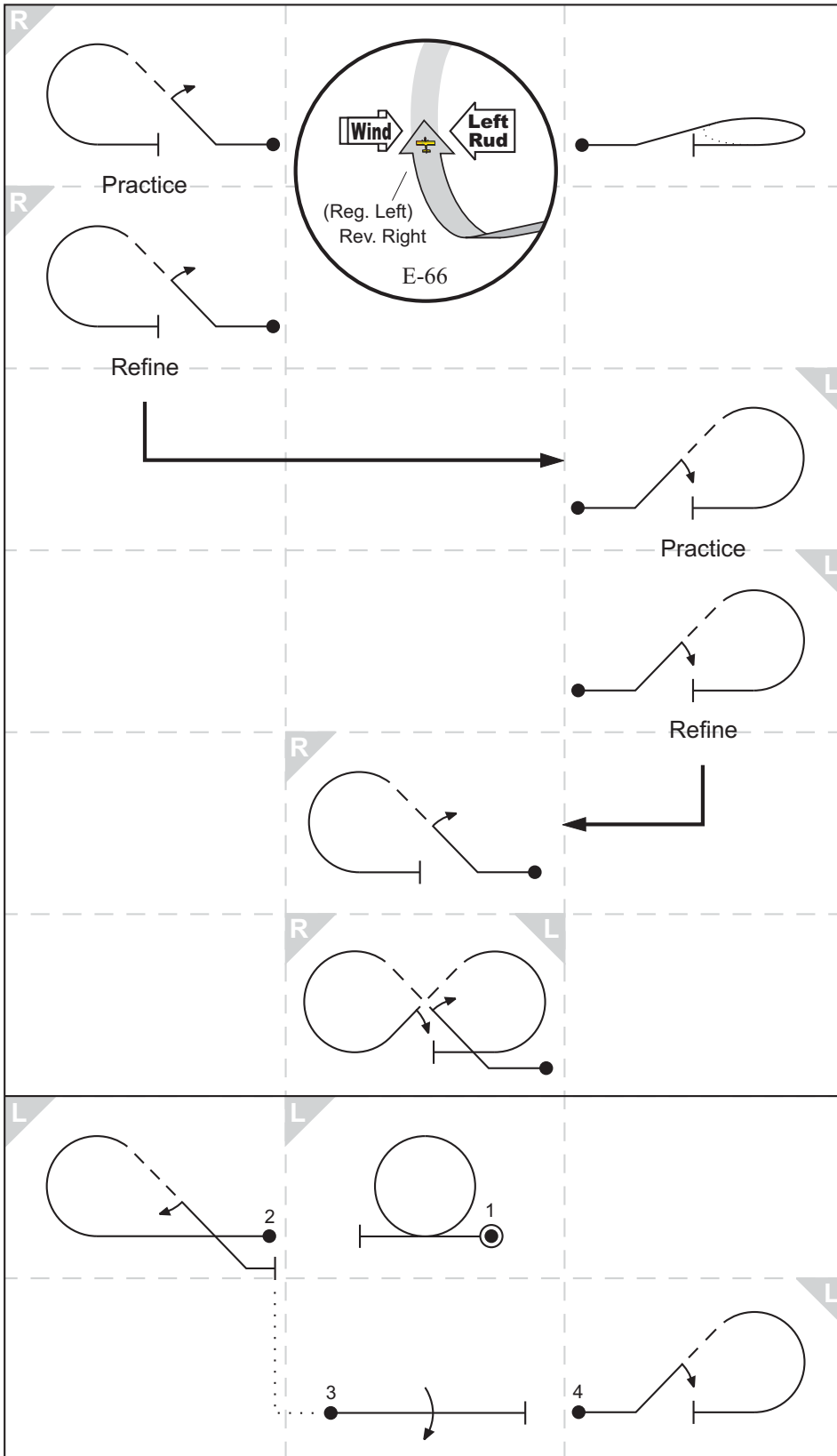

Practice wind correction in reverse Cuban at one end of field E-69

Refine wind correction

Practice wind correction in reverse Cuban at other end of field E-70

Refine

Wind correct half reverse Cuban at show center E-76

Full reverse Cuban w/wind corrections E-75

Wind correct pairs of maneuvers

Wind correct continuous aerobic sequence

KPTR: Consistent rudder corrections first require consistent loops (inputs).

F-95



# IN X-wind Instruction Outline



DAS  
PHASE II

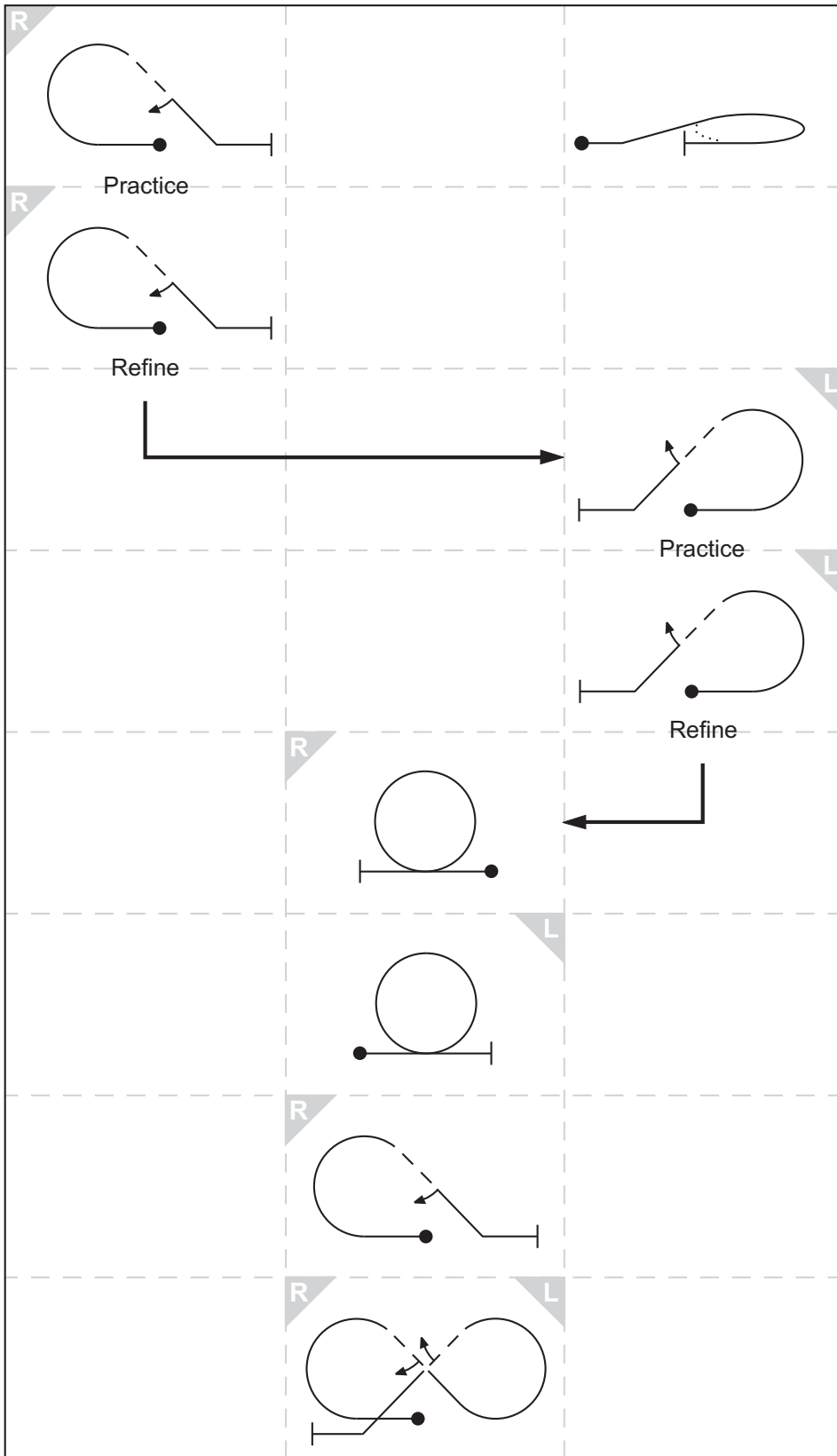

Practice rudder wind correction in Cuban at one end of field E-59

Refine wind correction

Practice wind correction in Cuban at other end of field E-60

Refine

Apply wind correction to loop at show center

Wind correct loop in opposite direction

Wind correct half Cuban at show center

Full Cuban w/wind corrections

KPTR: Consistency is possible only if your fingers remain on both sticks!



# IN X-wind Instruction Outline Cont.



DAS  
PHASE II

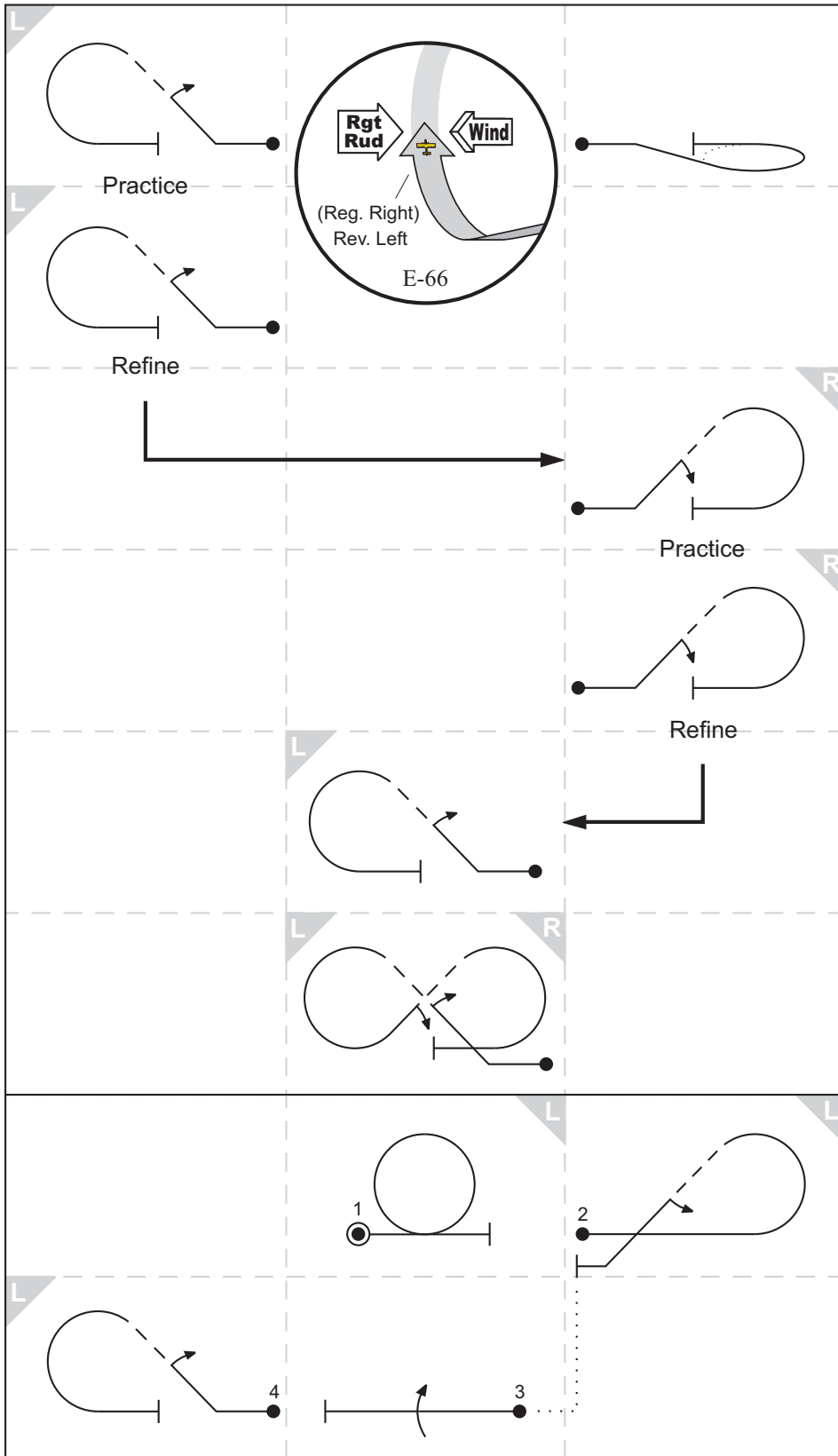

Practice wind correction in reverse Cuban at one end of field E-69

Refine wind correction

Practice wind correction in reverse Cuban at other end of field E-70

Refine

Wind correct half reverse Cuban at show center

Full reverse Cuban w/wind corrections

Wind correct pairs of maneuvers

Wind correct continuous aerobic sequence

KPTR: Look to correct the cause of errors, not to get better at correcting their consequences.